

AIR BALANCER RAIL SYSTEM



ENDO ENDO KOGYO CO., LTD.

3-14-7, Akibacho, Tsubame, Niigata, Japan
TEL : +81-256-62-5131 FAX. +81-256-62-5772
<https://www.endo-kogyo.co.jp>



ISO9001 JP97/010458
SCOPE : Head office, Plant



ISO14001 JP10/070952
SCOPE : Head office, Plant



ENDO KOGYO INDIA PVT. LTD.

101, First Floor, Aditya Towers
LullaNagar, Off Kondhwa Road, Pune - 411 040
TEL : +91-86-00042752 Mail. info@endo-india.co.in
<https://www.endo-india.co.in>

Safe and easy material handling with ENDO Air balancers!!

ENDO Air balancers are lifting and material maneuvering equipment powered by compressed air.

ENDO Air balancers assist material handling operations, reducing the burden on workers and increasing safe and efficiency.



short type

Reduce the weight burden of heavy materials

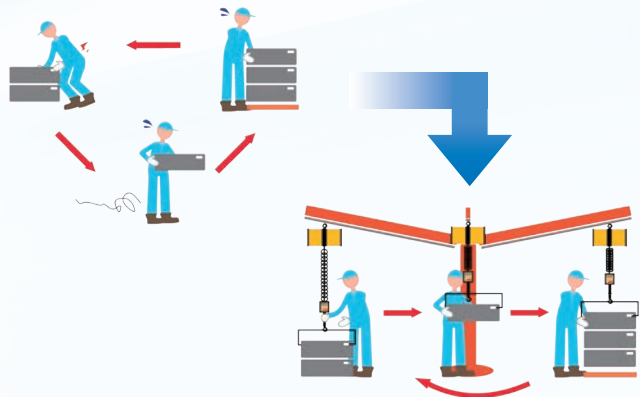

ENDO Air balancers assist with lifting, reducing the weight burden.

Improved efficiency

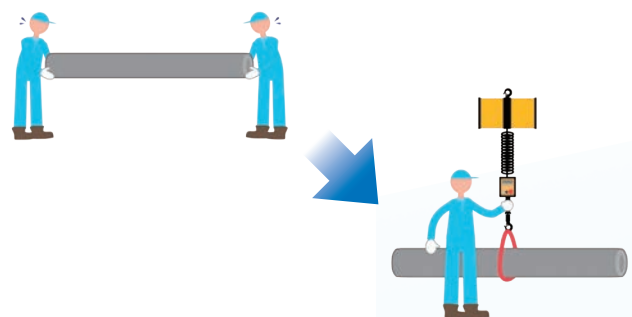

ENDO Air balancers increase precision, efficiency and safety.

Eliminate inching allowing for smooth handling

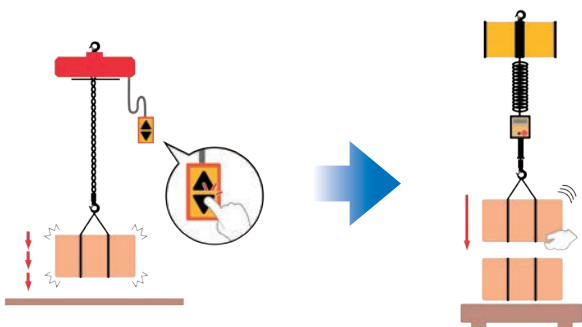

Workers can lift and maneuver the load by hand directly for precise positioning and careful landing.

Easy handling for all workers

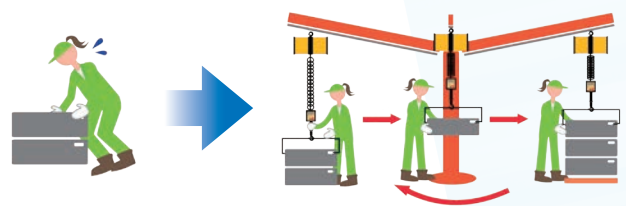

ENDO Air balancers allow for maneuverable operation. Useful for all levels of worker ability and training.

3 categories of ENDO Air balancers

Three categories of Air balancers are available with various applications according to operational needs.

Suitable for multiple weight loads



Hoisting and Balancing

Magical balancer
ABC >>> **P.03**



Hoisting and Floating

MS-A
MS/MSS
MS-ATC
MSD >>>>> **P.06**

For a single weight load



Balancing

BC1
BC2 >>>>>>> **P.10**

Three function features



Hoisting



Lift up and lower with switching.



Floating



Adjust the load position approximately 30cm by hand from the stop position.

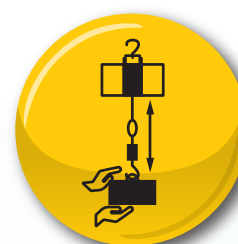

Balancing



With this function, manually adjust the load to any position on the stroke by hand.

● Down stop (Except MS, MSS and BC1)

The raised load will not fall even if the air supply is cut off or if hoses are damaged or broken.

● Energy-saving design

Air consumption of Air balancer is only 1/7 of that of the Air hoist. (comparing our existing model)

● Clean design

No lubrication is needed and produces no oil mist.

● Quiet design

With no air motor, Air balancer produces very little noise in operation.

POINT

ENDO Magical balancer

Models with balancing and hoisting functions

ENDO Magical balancer is a new generation Air balancer with enhanced safety, efficiency and maneuverability features, that automatically adjust the air pressure electronically.



● **ENDO Magical balancer is the perfect choice to...**

- ◆ Handle multiple loads
- ◆ Provide precise adjustment of the suspended loads

▶▶ **Balancing** (Balancing mode)

The suspend object is raised or lowered directly by hand.

▶▶ **Hoisting** (Grip control mode)

The suspend object is raised or lowered by sliding the grip controller.

Balancing mode



Grip control mode



- POINT 1**
- **Operational speed and maneuverability is not changed when the weight of the suspended load changes.**

The air pressure is automatically controlled electronically so that an ease of operation can be maintained at all times. Therefore, you can use it with the same feeling of operation without adjustment even if you suspend objects of different weights.

- POINT 2**
- **Operation modes are switched automatically**

Automatic switching between the balancing function and hoisting function, so there is no need to switch manually with a controller. A beep and a light will alert the user. Manual switching is also available.

Specifications

Model	Air pressure (MPa)	Lifting capacity (kg)	Mass (kg)	Wire rope dia. (mm)	Travel and dimensions (mm)						
					A	B (Standard model)		C (Compact model)			
						Travel	MIN.	MAX.	Travel	MIN.	MAX.
EDB-50	0.4	20	42	ø 4.76	378.5		1135	3035		885	1985
	0.5	30									
	0.6	40									
	0.7	50									
EDB-85	0.4	40	43		399	1900	1179	3079	1100	929	2029
	0.5	55									
	0.6	70									
	0.7	85									
EDB-130	0.4	61	50		452.5		1235	3135		985	2085
	0.5	84									
	0.6	107									
	0.7	130									

AC100-240V ※5m power cable is included standard.

Dimensions

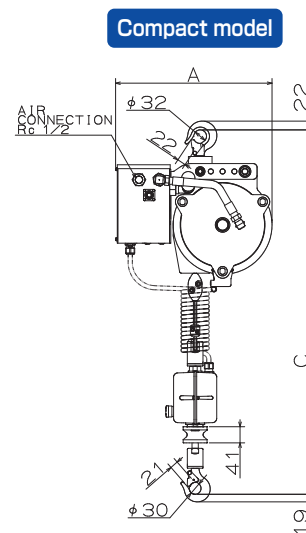
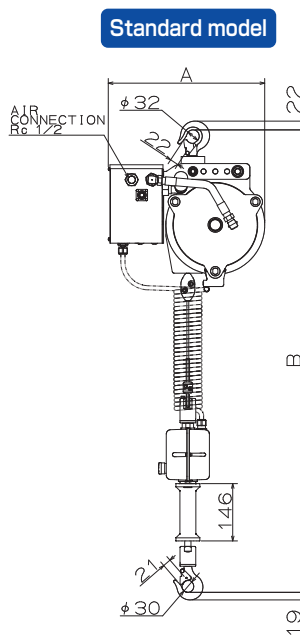
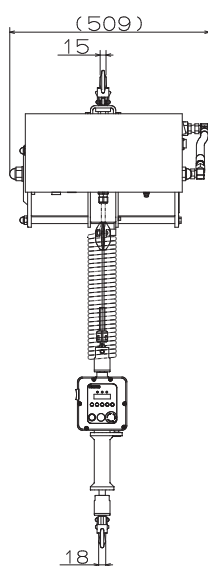

Travel 1.1m~
ENDO KOGYO will offer a recommendation based on the operational and usage requirements.

Options

A remote controller is available as an option for working environments where it is not possible to use the grip control.



Example of remote controller installation

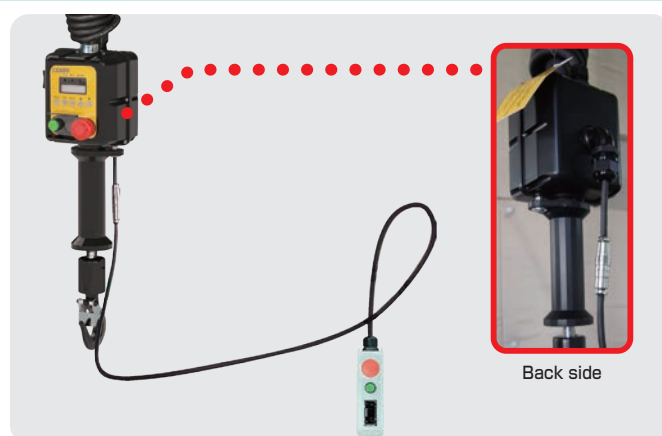

Type-ABC Full auto module

●Auto Balance

With Full auto module, the AIR BALANCER can automatically adjust itself to the weight of the hung load. The load can then be lifted and lowered by hand without using the controller.

●Adjustment of lifting and lowering speed

Both speeds are adjustable by turning the knob on control module.

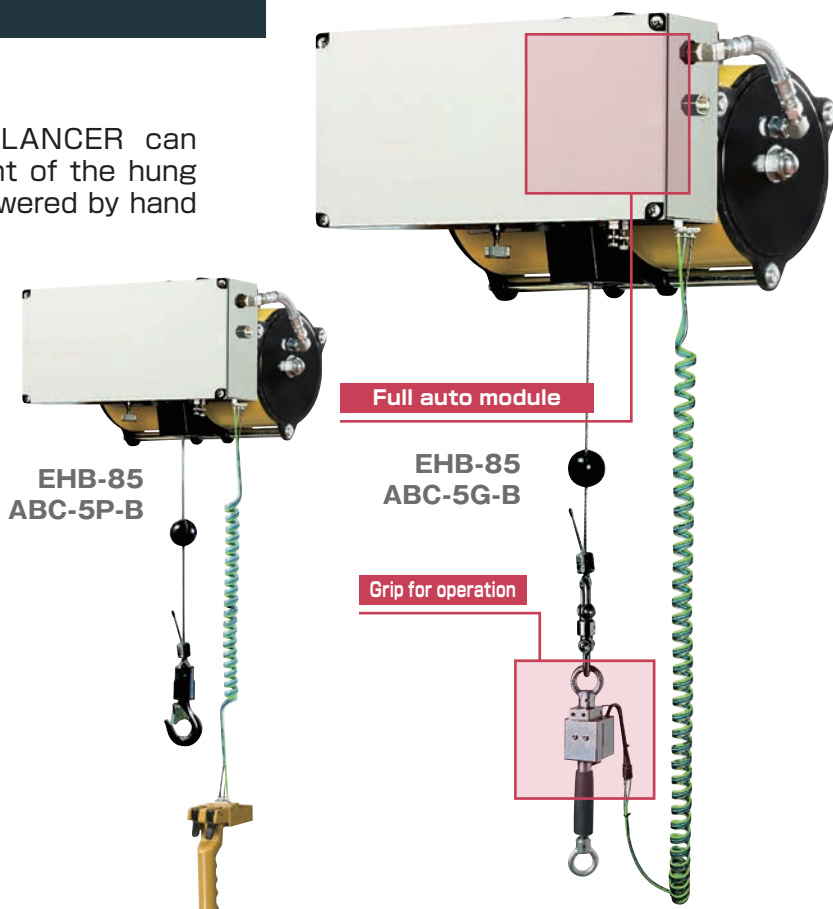

Control module	Model	Hose	Operation	Weight	Body
Full auto module	ABC-5P-B	Coil hose×3	Pendant	11kg	EHB-50S(C),50(C),85(C),130(C),270CR
Full auto module	ABC-5G-B	Coil hose×3	Grip	11kg	EHB-50S(C),50(C),85(C),130(C)

Specifications

() Show performances of the chain type

Model	Air pressure (MPa)	Max lifting capacity (kg)	Stroke (m)	Weight (kg) (*)	Cable dia (Wire rope type)	Chain size×Fall (Chain type)	Air inlet
EHB-50 EHB-50C	0.5	40	1.9 (1.8)	28 (29)	φ 4.76	4.0×1	Rc 3/8
	0.4	30					
	0.3	20					
EHB-85 EHB-85C	0.5	60	1.9 (1.8)	29 (30)			
	0.4	45					
	0.3	30					
EHB-130 EHB-130C	0.5	85	1.9 (1.8)	36 (37)			
	0.4	62.5					
	0.3	40					
EHB-270CR	0.5	160	0.9	43	—	4.0×2	
	0.4	115					
	0.3	70					

(*) Weight: Without module

POINT

●Auto Balance

Full auto module can recognize the weight of hung device from 0kg to Max lifting capacity so that the balancing can be controlled.

●Down stop

Added safety measure. Hung load will not fall even if the air supply is cut off or when hoses are broken.

●Energy-saving design

Air consumption of AIR BALANCER is only 1/7 of that of AIR HOIST. (comparing our existing model)

●Clean design

No lubrication is needed and produces no oil mist.

●Quiet design

With no air motor, AIR BALANCER produces very little noise in operation.

Type- **MS-A** Hoisting "WITH" DOWN STOP

AIR BALANCER is handling equipment powered by compressed air.

● Adjustment of lifting and lowering speed

Both speeds are adjustable by turning the knob on control module.

● Floating capability

By adding or reducing force directly onto the hung load, the load will move down or up respectively. The range of floating is about 35cm up and down from stable position.

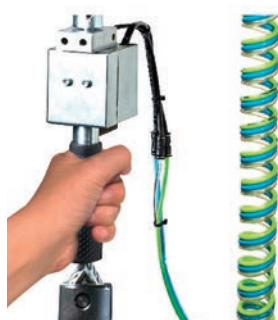

Grip for operation



Pendant for operation

Grip for operation

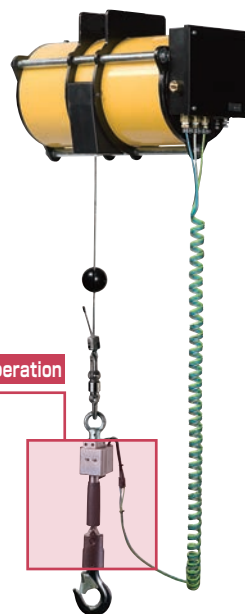

EHB-85+MS-AG



EHB-85+MS-A

Control module MS-A

Pendant for operation

Control module	Model	Hose	Operation	Weight	Body
Hoisting	MS-A	Straight hose×3	Pendant	3.5kg	All model
Hoisting	MS-AG	Coil hose×3	Grip	5kg	EHB-50S(C),50(C),85(C),130(C),270(C)

Specifications

() Show performances of the chain type

Model	Air pressure (MPa)	Max lifting capacity (kg)	Stroke (m)	Weight (kg) (*)	Cable dia (Wire rope type)	Chain size×Fall (Chain type)	Air inlet
EHB-50S EHB-50SC	0.7	55	0.7 (0.65)	21 (20)	φ 4.76	4.0×1	Rc 3/8
	0.6	48					
	0.5	40					
	0.4	32					
EHB-50 EHB-50C	0.7	55	1.9 (1.8)	28 (29)			
	0.6	48					
	0.5	40					
	0.4	32					
EHB-85 EHB-85C	0.7	90	1.9 (1.8)	29 (30)			
	0.6	75					
	0.5	62					
	0.4	50					
EHB-130 EHB-130C	0.7	140	1.9 (1.8)	36 (37)			
	0.6	120					
	0.5	100					
	0.4	80					
EHB-270 EHB-270C	0.7	270	1.9 (1.7)	43 (44)	φ 6		
	0.6	230					
	0.5	190					
	0.4	150					
EHB-270CR	0.7	270	0.9	43	—	4.0×2	
	0.6	230					
	0.5	190					
	0.4	150					
EHB-450CR	0.6	450	0.85	50			
	0.5	370					
	0.4	290					

(*) Weight: Without module

POINT

● Grip type controller

Grip type controller allows a more sensitive control of height of lift.

● Down stop

Added safety measure. Hung load will not fall even if the air supply is cut off or when hoses are broken.

● Energy-saving design

Air consumption of AIR BALANCER is only 1/7 of that of AIR HOIST. (comparing our existing model)

● Clean design

No lubrication is needed and produces no oil mist.

● Quiet design

With no air motor, AIR BALANCER produces very little noise in operation.

Type- **MS/MSS** Hoisting "WITHOUT" DOWN STOP

● Adjustment of lifting and lowering speed

Both speeds are adjustable by turning the knob on control module

● Floating capability

By adding or reducing force directly onto the hung load, the load will move down or up respectively. The range of floating is about 35cm up and down from stable position.



Control module	Model	Hose	Operation	Weight	Body
Hoisting	MS	Straight hose×2	Pendant	2kg	EHB-50S(C),50(C),85(C),130(C),270CR
Hoisting	MSS	Straight hose×2	Pendant	2.2kg	EHB-270(C),450CR

Specifications

() Show performances of the chain type

Model	Air pressure (MPa)	Max lifting capacity (kg)	Stroke (m)	Weight (kg) (*)	Cable dia (Wire rope type)	Chain size×Fall (Chain type)	Air inlet
EHB-50S EHB-50SC	0.7	55	0.7 (0.65)	21 (20)	φ 4.76	4.0×1	Rc 3/8
	0.6	48					
	0.5	40					
	0.4	32	1.9 (1.8)	28 (29)			
EHB-50 EHB-50C	0.7	55					
	0.6	48					
	0.5	40					
	0.4	32	1.9 (1.8)	29 (30)			
EHB-85 EHB-85C	0.7	90					
	0.6	75					
	0.5	62					
	0.4	50	1.9 (1.8)	36 (37)			
EHB-130 EHB-130C	0.7	140					
	0.6	120					
	0.5	100					
	0.4	80	1.9 (1.7)	43 (44)	φ 6		
EHB-270 EHB-270C	0.7	270					
	0.6	230					
	0.5	190					
	0.4	150	0.9	43	—		
EHB-270CR	0.7	270					
	0.6	230					
	0.5	190					
	0.4	150	0.85	50	4.0×2		
EHB-450CR	0.6	450					
	0.5	370					
	0.4	290					

(*) Weight: Without module

● Economical model

● energy-saving design

Air consumption of AIR BALANCER is only 1/7 of that of AIR HOIST. (comparing our existing model)

● Clean design

No lubrication is needed and produces no oil mist.

● Quiet design

With no air motor, AIR BALANCER produces very little noise in operation.

NOTICE

DOWN STOP is available when the air supply is stopped but it is "NOT" available when hose for lowering control is cut.

POINT

Type-MSD Hoisting with inertia prevention unit

Adjustment of lifting and lowering speed

Both speeds are adjustable by turning the knob on control module.

Inertia prevention unit

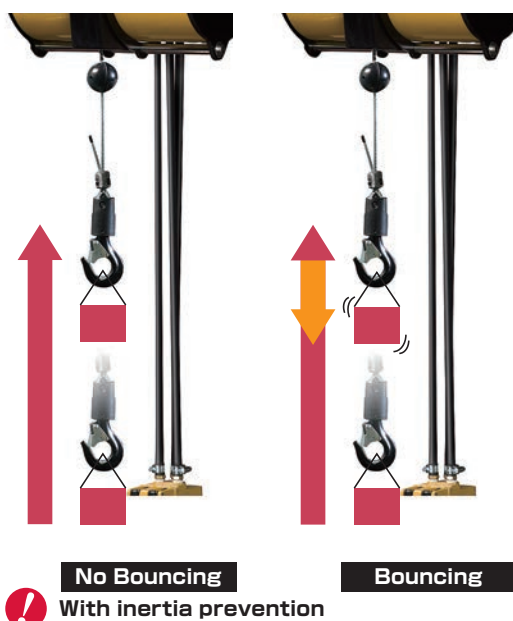

EHB-85D MSD

Control module MSD

Pendant for operation

Control module	Model	Hose	Operation	Weight	Body
Hoisting	MSD	Straight hose×3	Pendant	6kg	EHB-85D

Specifications

Model	Air pressure (MPa)	Max lifting capacity (kg)	Stroke (m)	Weight (kg) (*)	Cable dia (mm)	Air inlet
EHB-85D	0.7	90	1.9	34	φ4.76	Rc 3/8
	0.6	75				
	0.5	62				
	0.4	50				

(*) Weight: Without module

POINT

Inertia prevention unit

Accurate positioning by pendant control is made possible. (Brake eliminates the bouncing effect)

Down stop

Added safety measure. Hung load will not fall even if the air supply is cut off or when hoses are broken.

Energy-saving design

Air consumption of AIR BALANCER is only 1/7 of that of AIR HOIST. (comparing our existing model)

Clean design

No lubrication is needed and produces no oil mist.

Quiet design

With no air motor, AIR BALANCER produces very little noise in operation.

Type- MS-ATC

Hoisting for at-hand operation

● Much smoother operation

UP and Down button and handle are equipped on lower hook. Comparing with independent pendant control, load lifts and lowers smoother and stably.



Hook built-in pendant for operation

EHB-85+MS-ATC

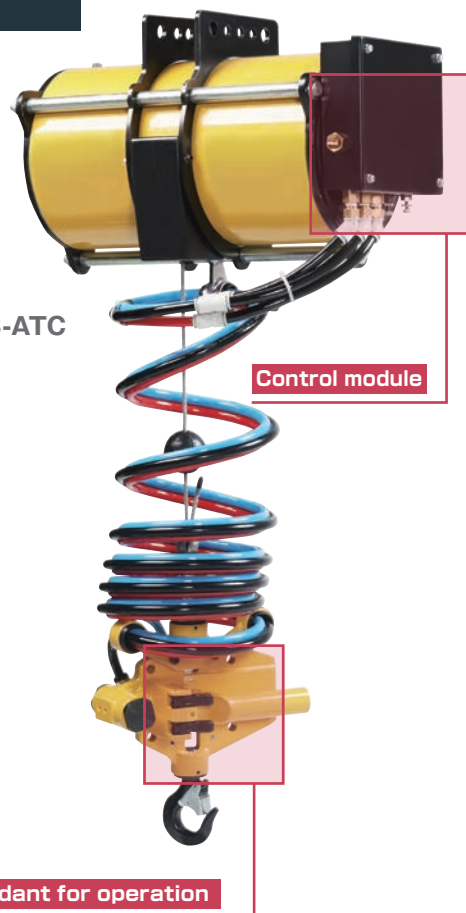

Control module	Model	Hose	Operation	Weight	Body
Hoisting	MS-ATC	Coil hose×3	Pendant	6kg	EHB-50S(C),50(C),85(C),130(C)

Specifications

() Show performances of the chain type

Model	Air pressure (MPa)	Max lifting capacity (kg)	Stroke (m)	Weight (kg) (*)	Cable dia (Wire rope type)	Chain size×Fall (Chain type)	Air inlet
EHB-50S EHB-50SC	0.7	55	0.7 (0.65)	21 (20)	φ 4.76	4.0×1	Rc 3/8
	0.6	48					
	0.5	40					
	0.4	32					
EHB-50 EHB-50C	0.7	55	1.9 (1.8)	28 (29)			
	0.6	48					
	0.5	40					
	0.4	32					
EHB-85 EHB-85C	0.7	90	1.9 (1.8)	29 (30)			
	0.6	75					
	0.5	62					
	0.4	50					
EHB-130 EHB-130C	0.7	140	1.9 (1.8)	36 (37)			
	0.6	120					
	0.5	100					
	0.4	80					

(*) Weight: Without module

POINT

● At-hand operation

This module is pendant type which can be operated at-hand and enables you to control hoisting and lowering with stable condition of the load.

● Down stop

Added safety measure. Hung load will not fall even if the air supply is cut off or when hoses are broken.

● Energy-saving design

Air consumption of AIR BALANCER is only 1/7 of that of AIR HOIST. (comparing our existing model)

● Clean design

No lubrication is needed and produces no oil mist.

● Quiet design

With no air motor, AIR BALANCER produces very little noise in operation.

Load Chain type

- **AIR BALANCER with alloy steel loadchain.**
Tougher and more durable.

Double chain type (CR)

Single chain type (C)

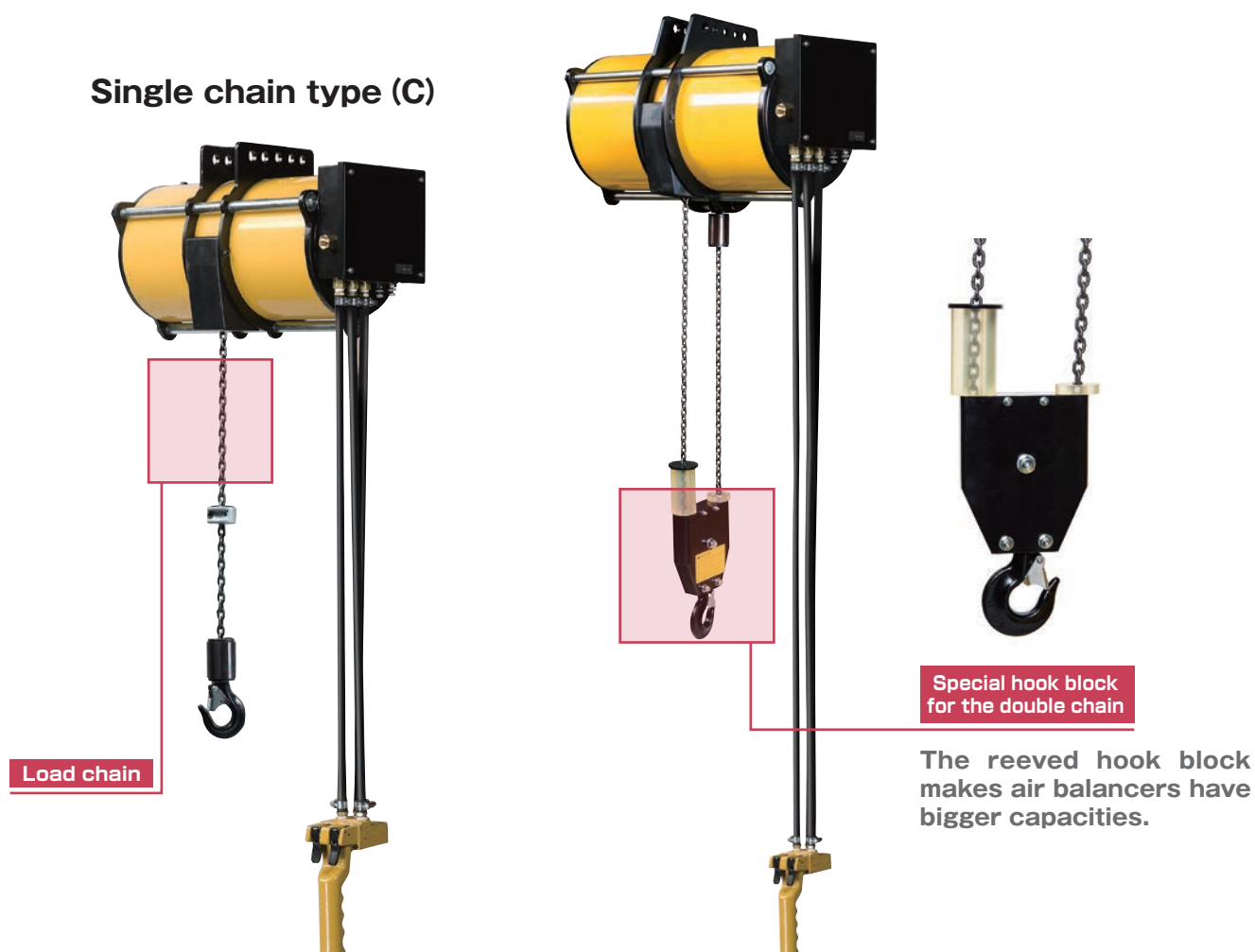

Specifications

Model	Stroke (m)	Weight (kg)	Size×Fall	Control module							
				MS-A	MS-AG	MS-ATC	MS/MSS	ABC-5P-B	ABC-5G-B	BC1	BC2
EHB-50SC	0.65	20	4.0×1								
EHB-50C	1.8	29		✓	✓	✓	✓	✓	✓	✓	✓
EHB-85C	1.8	30									
EHB-130C	1.8	37									
EHB-270C	1.7	44	4.0×2	✓			✓				
EHB-270CR	0.9	43		✓			✓	✓		✓	✓
EHB-450CR	0.85	50		✓			✓				

Type-BC2 Dual Balance module

Dual Balancing

The Dual Balance Module with its 2 regulators allows the balancing of 2 different weights, which provides easier transfer or mounting of load.

- Full stroke balancing by hand.
- 2 different weights can be balanced.
- 2 different kinds of balanced weight set in advance can be changed by pushing button on pendant.

Weight switching button



Optional design

Bracket

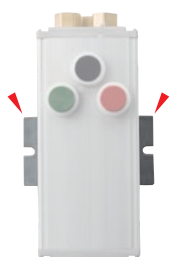

Knob (for BC2-H)



Coil hose



EHB-85+BC2

Dual Balance module

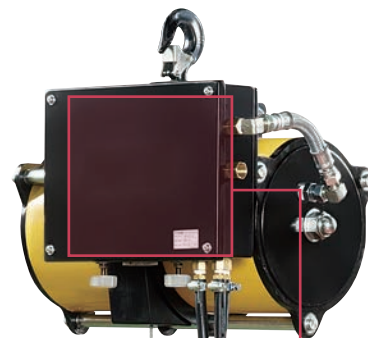

Switching button



Control module	Model	Hose	Weight	Body
Dual Balance module	BC2	Straight hose×3	4kg	EHB-50S(C),50(C),85(C),
Dual Balance module	BC2-H	Straight hose×3	4kg	130(C),270CR

Specifications

() Show performances of the chain type

Model	Air pressure (MPa)	Max lifting capacity (kg)	Stroke (m)	Weight (kg) (*)	Cable dia (Wire rope type)	Chain size×Fall (Chain type)	Air inlet
EHB-50S EHB-50SC	0.7	55	0.7 (0.65)	21 (20)	φ 4.76	4.0×1	Rc 3/8
	0.6	48					
	0.5	40					
	0.4	32					
EHB-50 EHB-50C	0.7	55	1.9 (1.8)	28 (29)			
	0.6	48					
	0.5	40					
	0.4	32					
EHB-85 EHB-85C	0.7	90	1.9 (1.8)	29 (30)			
	0.6	75					
	0.5	62					
	0.4	50					
EHB-130 EHB-130C	0.7	140	1.9 (1.8)	36 (37)			
	0.6	120					
	0.5	100					
	0.4	80					
EHB-270CR	0.7	270	0.9	43	—	4.0×2	
	0.6	230					
	0.5	190					
	0.4	150					

(*) Weight: Without module

POINT

Dual Balance

2 weights whose range is from 0kg to Max lifting capacity can be set to regulator. The loads with this 2 different weights can be balanced.

Down stop

Hung load will go down slowly when the air supply is cut off or silver hose is broken.

Energy-saving design

Air consumption of AIR BALANCER is only 1/7 of that of AIR HOIST. (comparing our existing model)

Clean design

No lubrication is needed and produces no oil mist.

Quiet design

With no air motor, AIR BALANCER produces very little noise in operation.

Type-BC1 Single Balance module

● Single Balancing

The hung load will be balanced after the regulator is set to the weight.

This module makes it easy for an operator to lift and lower a load.

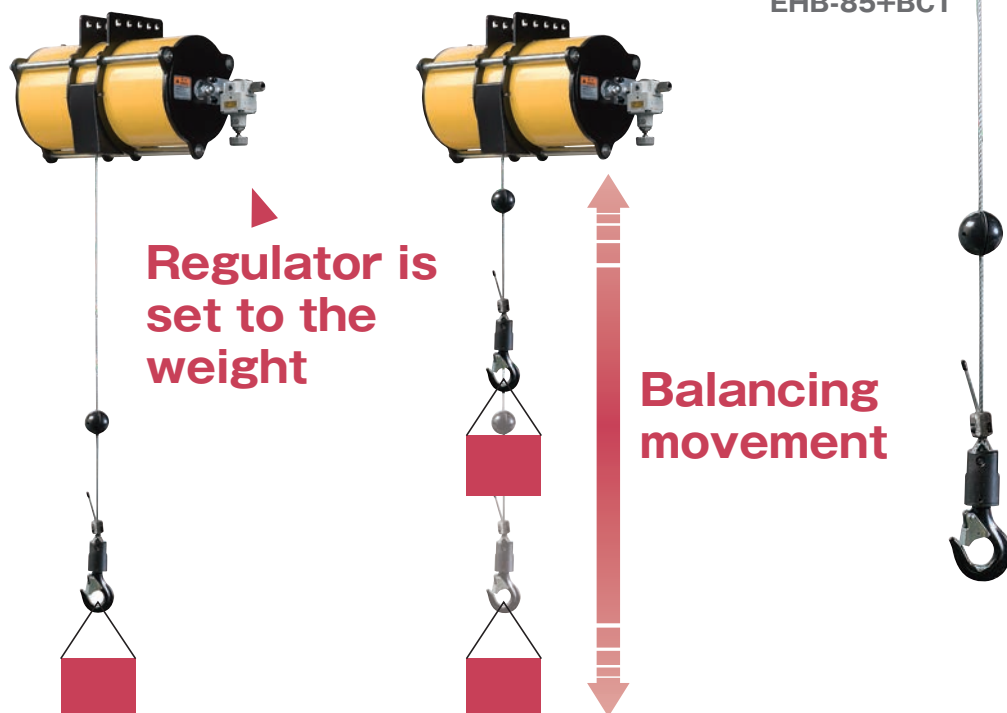

EHB-85+BC1

Balance module

Control module	Model	Weight	Body
Single Balance module	BC1	1kg	EHB-50S(C),50(C),85(C),130(C),270CR

Specifications

() Show performances of the chain type

Model	Air pressure (MPa)	Max lifting capacity (kg)	Stroke (m)	Weight (kg) (*)	Cable dia (Wire rope type)	Chain size×Fall (Chain type)	Air inlet
EHB-50S EHB-50SC	0.7	55	0.7 (0.65)	21 (20)	φ 4.76	4.0×1	Rc 3/8
	0.6	48					
	0.5	40					
	0.4	32					
EHB-50 EHB-50C	0.7	55	1.9 (1.8)	28 (29)			
	0.6	48					
	0.5	40					
	0.4	32					
EHB-85 EHB-85C	0.7	90	1.9 (1.8)	29 (30)			
	0.6	75					
	0.5	62					
	0.4	50					
EHB-130 EHB-130C	0.7	140	1.9 (1.8)	36 (37)			
	0.6	120					
	0.5	100					
	0.4	80					
EHB-270CR	0.7	270	0.9	43	—	4.0×2	
	0.6	230					
	0.5	190					
	0.4	150					

(*) Weight: Without module

POINT

● Single Balance

Range of 0kg to Max lifting capacity can be balanced.

● Down stop

Hung load will go down slowly when the air supply is cut off.

● Energy-saving design

Air consumption of AIR BALANCER is only 1/7 of that of AIR HOIST. (comparing our existing model)

● Clean design

No lubrication is needed and produces no oil mist.

● Quiet design

With no air motor, AIR BALANCER produces very little noise in operation.

NOTICE

Suspending load will go down slowly with time if the air supply is stopped.

JIB CRANE

● Rail system for less space

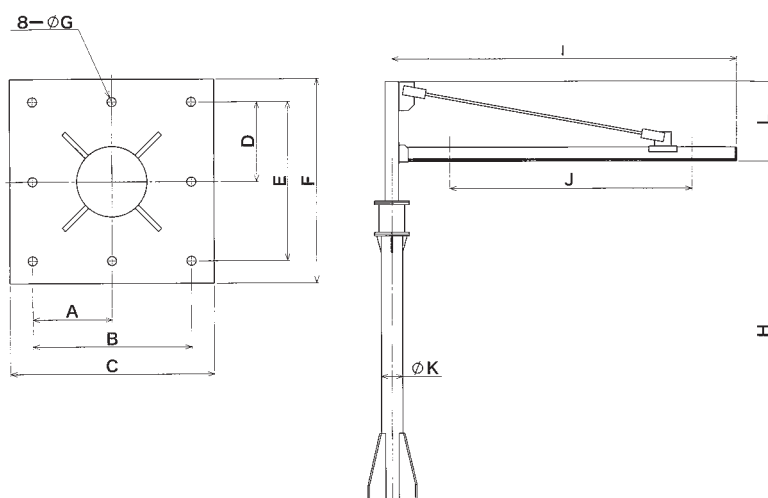

Dimensions

Model	A (mm)	B (mm)	C (mm)	D (mm)	E (mm)	F (mm)	G (mm)	H (mm)	I (mm)	J (mm)	K (mm)	L (mm)	Weight (kg)
EJS-2-20-300	230	460	500	230	460	500	φ20	2,000	2,095	1,140	φ216.8	700	300
EJS-2-30-265	230	460	500	230	460	500	φ20	3,000	2,095	1,315	φ216.8	700	265
EJS-3-20-170	230	460	500	230	460	500	φ20	2,000	3,095	2,235	φ216.8	900	170
EJS-3-30-150	230	460	500	230	460	500	φ20	3,000	3,095	2,235	φ216.8	900	150
EJB-2-20-400	280	560	600	280	560	600	φ20	2,000	2,110	1,140	φ267.4	700	400
EJB-2-30-400	280	560	600	280	560	600	φ20	3,000	2,110	1,140	φ267.4	700	400
EJB-3-30-250	280	560	600	280	560	600	φ20	3,000	3,110	2,235	φ267.4	900	250
EJB-4-30-120	280	560	600	280	560	600	φ20	3,000	4,110	3,235	φ267.4	900	120

※More models are available. Feel free to ask us.

Attachment

■ Pantograph type



■ 2 points hook type

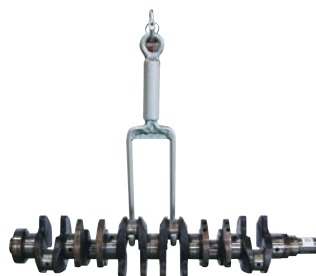

※We can customize for your request.

An excellent transfer system employing the benefits of aluminum and rail system

- 1 Great movability. Enables load transfer with the shortest distance travel and thus faster working time.
- 2 Standardization for parts makes it easy for relocation and expansion.
- 3 The parts come with kits and are joint using bolts; easy to assemble and repair.
- 4 Compared to steel rail, aluminum is lighter and stronger. With anodized treatment, our aluminum rails are more corrosive resistant, more durable, and looks better.
- 5 Precision machining on our rails and resin wheels allow smooth travel with little friction.

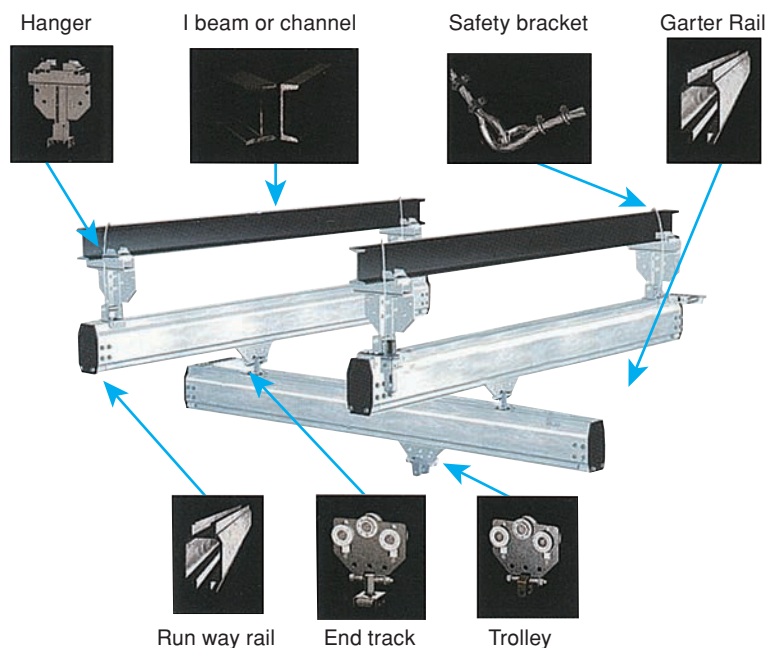

Aluminum alloy rail

Model	Measurement (mm)	Unit weight	Rail length
TR2000		3.6kg/m	2inch
RAD4110		6.44kg/m	4inch
RAD7510		12.26kg/m	8inch

There are various trolley suited to your needs.
 Special trolleys are available for 2, 4 and 8 inch rails.
 Maximum loadings are;
 2 inch ... 180kg
 4 inch ... 250kg
 8 inch ... 490kg

Relation between lifting span and lifting load Unit:Kgf

Rail length	TR2000	RAD4110	RAD7510
	Lifting load	Lifting load	Lifting load
1m	200	500	500
2m	100	500	500
3m	45	250	500
4m	25	140	500
5m	16	90	470
6m	11	60	330

Accessories

EHB Trolley

(Applicable width of beam 75, 100mm)



Dimensions

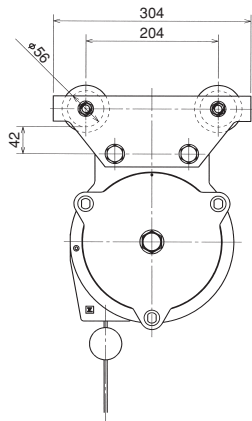

Body	Part No.
Wire rope Single chain	LHP001899
Double chain	LHP002714

EHB Hook set



Dimensions

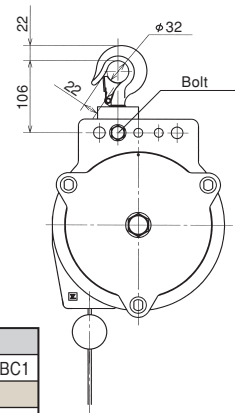

Body	Part No.	Correspond module
Wire rope Single chain	LHP001900	MS, MS-A, MS-AG, MS-ATC, BC1
	LHP001991	MSD
	LHP002146	BC2, ABC
Double chain	LHP002691	MS, MS-A, BC1
	LHP002700	BC2, ABC-5P-B

Dimensions

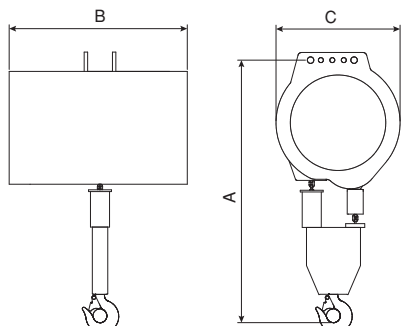
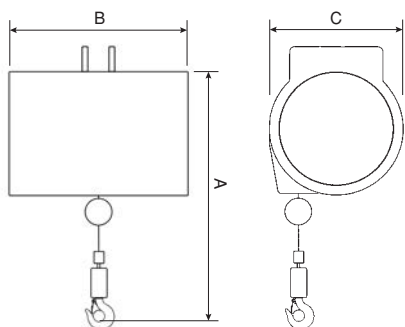

Double chain type

*() shows dimensions of chain type.

Model	Module	Dimensions (mm)			
		A		B	C
		MIN.	MAX.		
EHB-50S EHB-50SC	MS	526(517)	1226(1167)	337	211
	MS-A	526(517)	1226(1167)	362	211
	MS-AG	921(912)	1621(1562)	362	211
	MS-ATC	704(695)	1404(1345)	362	211
	ABC-5P-B	526(517)	1226(1167)	478	363
	ABC-5G-B	811(802)	1511(1452)	478	363
	BC1	526(517)	1226(1167)	416	211
EHB-50 EHB-50C	BC2	526(517)	1226(1167)	347	319
	MS	526(517)	2426(2317)	473	211
	MS-A	526(517)	2426(2317)	498	211
	MS-AG	921(912)	2821(2712)	498	211
	MS-ATC	704(695)	2604(2495)	498	211
	ABC-5P-B	526(517)	2426(2317)	516	363
	ABC-5G-B	811(802)	2711(2602)	516	363
EHB-85 EHB-85C	BC1	526(517)	2426(2317)	552	211
	BC2	526(517)	2426(2317)	495	319
	MS	570(560)	2470(2360)	466	252
	MS-A	570(560)	2470(2360)	491	252
	MS-AG	965(955)	2865(2755)	491	252
	MS-ATC	746(736)	2646(2536)	491	252
	ABC-5P-B	570(560)	2470(2360)	516	386
EHB-85D	ABC-5G-B	853(843)	2753(2643)	516	386
	BC1	570(560)	2470(2410)	545	252
	BC2	570(560)	2470(2410)	495	340
	MSD	570	2470	520	326
EHB-130 EHB-130C	MS	652(629)	2552(2429)	469	305
	MS-A	652(629)	2552(2429)	494	305
	MS-AG	1020(997)	2920(2797)	494	305
	MS-ATC	803(780)	2703(2580)	494	305
	ABC-5P-B	652(629)	2552(2429)	516	440
	ABC-5G-B	910(887)	2810(2687)	516	440
	BC1	652(629)	2552(2429)	547	305
EHB-270 EHB-270C	BC2	652(629)	2552(2429)	495	393
	MSS	652(629)	2452(2329)	591	305
	MS-A	652(629)	2452(2329)	616	305
EHB-270CR	MS	688	1538	469	325
	MS-A	688	1588	494	325
	ABC-5P-B	688	1588	516	462
	BC1	688	1588	547	325
	BC2	688	1588	495	418
EHB-450CR	MSS	688	1538	591	325
	MS-A	688	1538	616	325